

LEGEND	
	PROJECT LOCATION
	EELGRASS BEDS
	45m EELGRASS BUFFER
	250m EELGRASS BUFFER



**FIGURE 1-1.**  
 LOCATION MAP:  
 VALERO REFINING COMPANY, BENICIA, CA

**PACIFIC ECORISK** ENVIRONMENTAL CONSULTING & TESTING

**USACE File: SPN-2012-00248**  
 Valero Benicia Refinery Maintenance Dredging  
 Sheet 1 of 6                      Date: April 2023



**LEGEND**

-  PROJECT LOCATION
-  PERMITTED DREDGE BOUNDARY
-  EELGRASS BEDS

**FIGURE 1-2.**

VICINITY MAP:  
VALERO REFINING COMPANY, BENICIA, CA

 **PACIFIC ECORISK** || ENVIRONMENTAL CONSULTING & TESTING

**USACE File: SPN-2012-00248**  
Valero Benicia Refinery Maintenance Dredging  
Sheet 2 of 6      Date: April 2023



**FIGURE 1-3.**  
PROJECT OVERVIEW: VALERO REFINING COMPANY



**USACE File: SPN-2012-00248**  
 Valero Benicia Refinery Maintenance Dredging  
 Sheet 3 of 6      Date: April 2023

**ESTIMATED QUANTITIES WITHIN AREA 1**

0 TO -40= 17,145 CY  
 -40 TO -42= 8,493 CY  
 -42 TO -44 = 11,748 CY

**TOTAL: 37,836 CY**

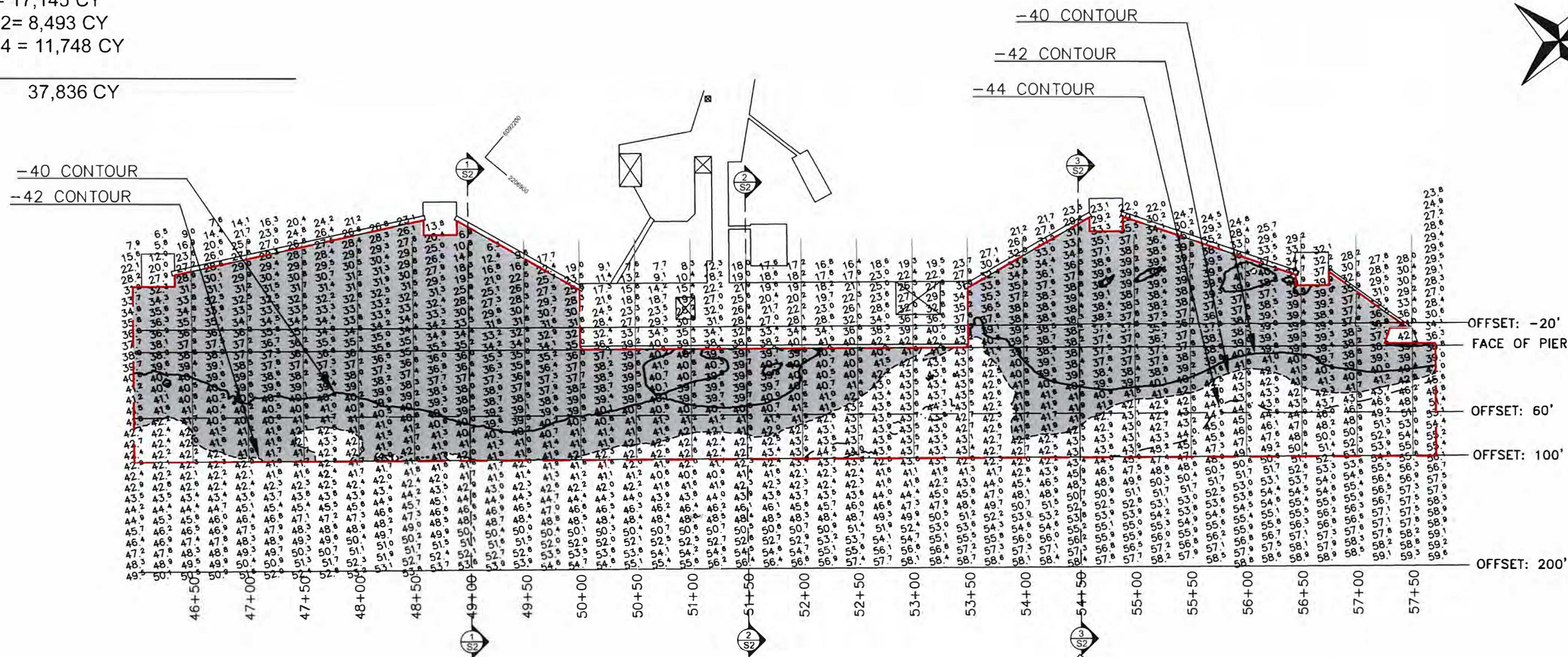
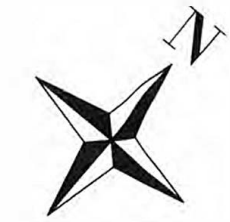

**LEGEND:**

- -40 CONTOUR
- -42 CONTOUR
- -44 CONTOUR

- DREDGE AREA WITHIN THE -42 FT CONTOUR (141,885 SQ. FT. = 3.26 ACRES)
- AREA 1 (TERMINAL BERTH) LIMITS

**Survey Certification**  
 I certify that to the best of my knowledge, this survey is accurate.

SIGNATURE:   
 DATE: 11/2/22

John Lazorik, Environmental Staff Engineer  
 on behalf of Valero Refining Company-California

USACE File: SPN-2012-00248  
 Valero Benicia Refinery Maintenance Dredging  
 Sheet 4 of 6 Date: April 2023

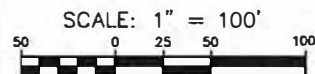

IF SHEET IS LESS THAN 11"x17"  
 IT IS A REDUCED PRINT,  
 SCALE ACCORDINGLY

**GENERAL NOTES:**

1. SURVEY DATA COLLECTED ON DECEMBER 27, 2021
2. HORIZONTAL DATUM/PROJECTION: NAD83 (2011) SPCS CALIFORNIA ZONE 03 - U.S. SURVEY FEET
3. HORIZONTAL CONTROL: ETRAC REFERENCE STATION: MARTINEZ 38°01'24.75685" N, 122°08'12.23358" W
4. VERTICAL DATUM: MLLW, U.S. SURVEY FEET
5. THIS SURVEY REPRESENTS GENERAL CONDITIONS AT THE TIME OF THE SURVEY.

eTrac Inc.  
 637 LINDARO STREET  
 SUITE 100  
 SAN RAFAEL, CA 94901  
 415.462.0421  
 eTracInc.com

SURVEY DATE: DECEMBER 27, 2021	PLOT DATE: JANUARY 07, 2022
DRAWN BY: GWG	CHECKED BY: EHM
EPISODE# 22 EVENT# 1	ACOE PERMIT# 2021-00248S
FILE NAME: VALE_20211227_BeniciaRefinery_DMMO.dwg	

**BENICIA REFINERY  
 VALERO  
 PRE-DREDGE SURVEY  
 SOUNDINGS**

Reference Number:  
**S1**

VALERO CRUDE WHARF CROSS SECTION 1:

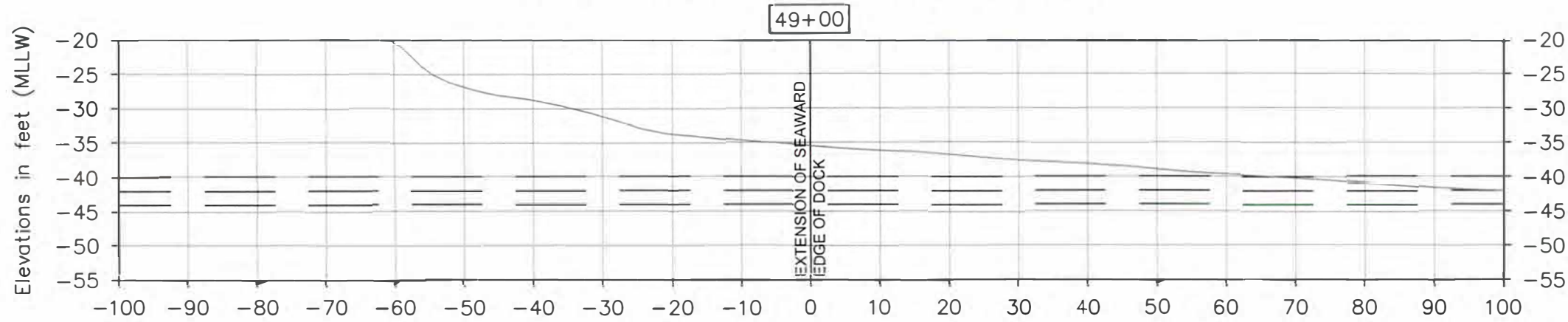

LEGEND:

Survey Performed on December 27, 2021

VALERO CRUDE WHARF CROSS SECTION 2:

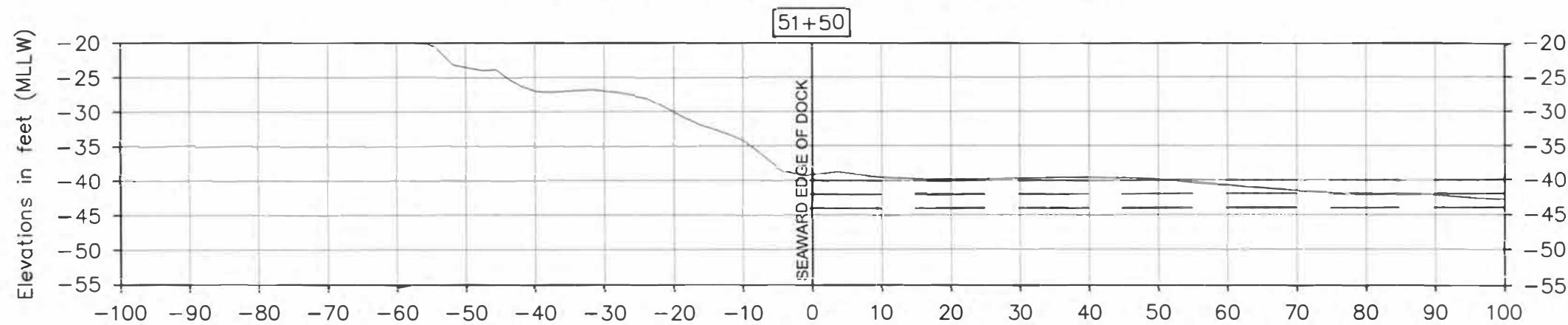

VALERO CRUDE WHARF CROSS SECTION 3:

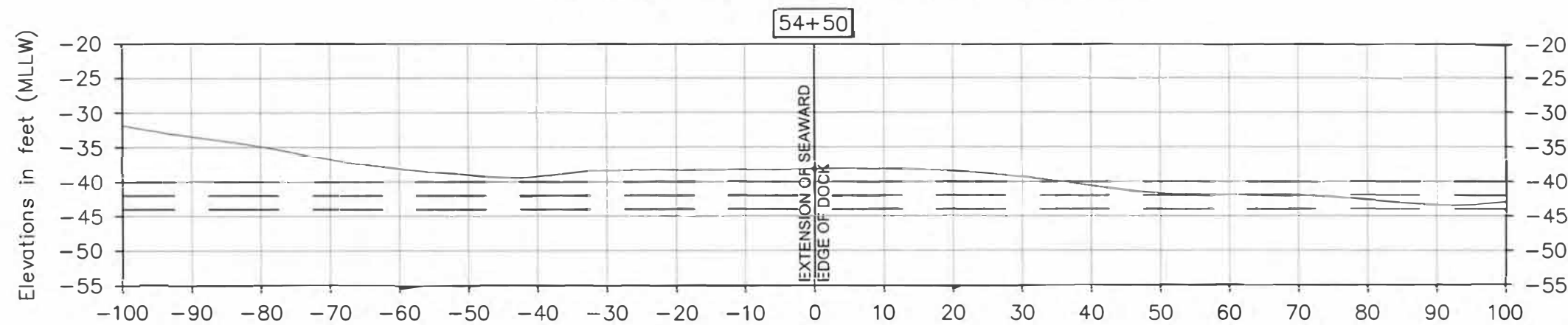

USACE File: SPN-2012-00248  
 Valero Benicia Refinery Maintenance Dredging  
 Sheet 5 of 6 Date: April 2023

GENERAL NOTES:

1. SURVEY DATA COLLECTED ON DECEMBER 27, 2021
2. HORIZONTAL DATUM/PROJECTION: NAD83 (2011) SPCS CALIFORNIA ZONE 03 - U.S. SURVEY FEET
3. HORIZONTAL CONTROL: ETRAC REFERENCE STATION: MARTINEZ 38°01'24.75685" N, 122°08'12.23358" W
4. VERTICAL DATUM: MLLW, U.S. SURVEY FEET
5. THIS SURVEY REPRESENTS GENERAL CONDITIONS AT THE TIME OF THE SURVEY.



eTrac Inc.  
 637 LINDARO STREET  
 SUITE 100  
 SAN RAFAEL, CA 94901  
 415.462.0421  
 eTracInc.com

SURVEY DATE: DECEMBER 27, 2021	PLOT DATE: JANUARY 07, 2022
DRAWN BY: GWG	CHECKED BY: EHM
EPISODE# 22 EVENT# 1	ACOE PERMIT# 2021-00248S
FILE NAME: VALE_20211227_BeniciaRefinery_DMMO.dwg	

BENICIA REFINERY  
 VALERO  
 PRE-DREDGE SURVEY  
 CROSS-SECTIONS

Reference Number:  
**S2**

# Dredged Sediment Placement Locations

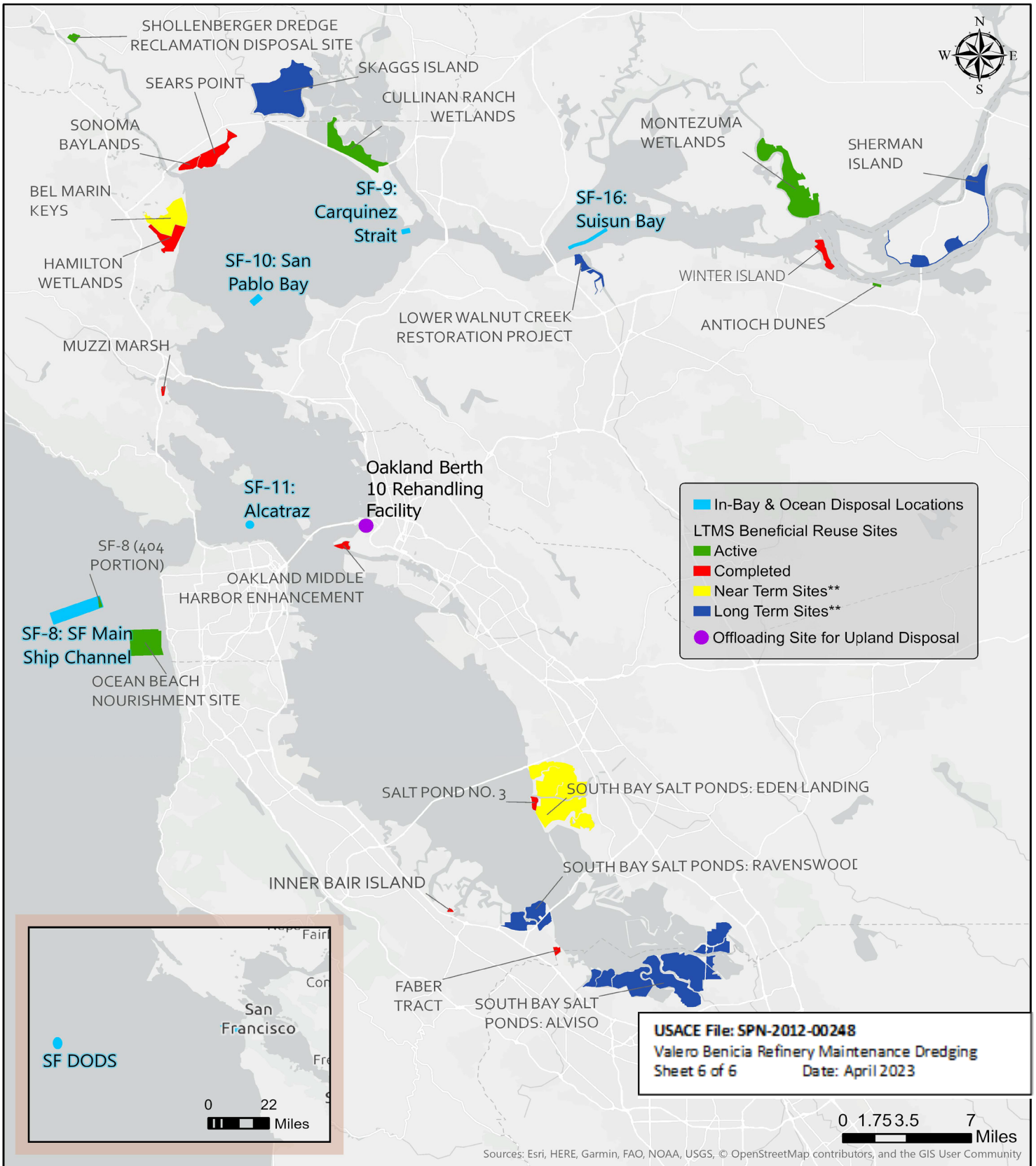

\*Sites located within LTMS Program Area, as of May 2020. Does not represent all sites where beneficial reuse is possible or has occurred.  
 \*\*Preliminarily defined as being available to receive dredged material within the next three years (Near Term Sites) or more than three years (Long Term Sites).