



NAVAL STATION TREASURE ISLAND

Digging in Gateview Avenue

The United States Navy is continuing its environmental cleanup actions within the residential neighborhood. This notice is to inform residents of a single small area in Gateview Avenue where the Navy will dig a 6 foot by 6 foot hole in order to service an underground water pipe. This flyer provides information on how and where the work will be conducted.

What Can I Expect?

Work Activities	<ul style="list-style-type: none">• Work will occur between 8 a.m. and 5 p.m. during the following dates:<ul style="list-style-type: none">– April 5, 2017 to April 6, 2017 (excavation and backfill)– April 10 (replace asphalt)• The field teams will be 4-6 people with digging equipment and a truck.• The dig area (approx. 6 feet by 6 feet and 5 feet deep) will take no more than 2 days to complete (including dig and backfill).• The dig will require blocking off the driveways for Building 1312 Units C and D during the two days of digging and backfill. Parking directly in front of Building 1312 along Gateview Avenue will be blocked off during these two days.• While the work is being conducted, the work area will be created using orange cones, traffic barricades, and caution tape. Flagmen will be present to direct traffic during the excavation and backfill. A steel trench plate will be placed over the dig area during non-working hours. For your safety, please give the workers space and do not enter this area.
Parking	<ul style="list-style-type: none">• Work may temporarily affect parking immediately adjacent to the dig area during working hours.
Noise	<ul style="list-style-type: none">• General construction noise may be heard during working hours; including digging equipment and a truck.
Dust	<ul style="list-style-type: none">• The Navy's contractor will be diligent in minimizing and controlling dust in the dig area.

If you have questions or comments concerning this field event, please contact Keith Forman, the BRAC Environmental Coordinator (BEC), at keith.s.forman@navy.mil, 415-308-1458.

Excavations to Cap Water Lines Along Gateview Avenue and Permieter Road

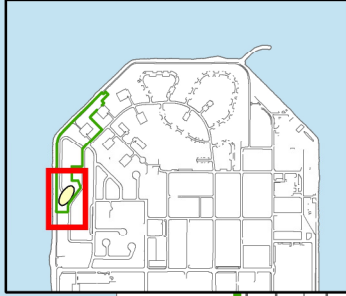





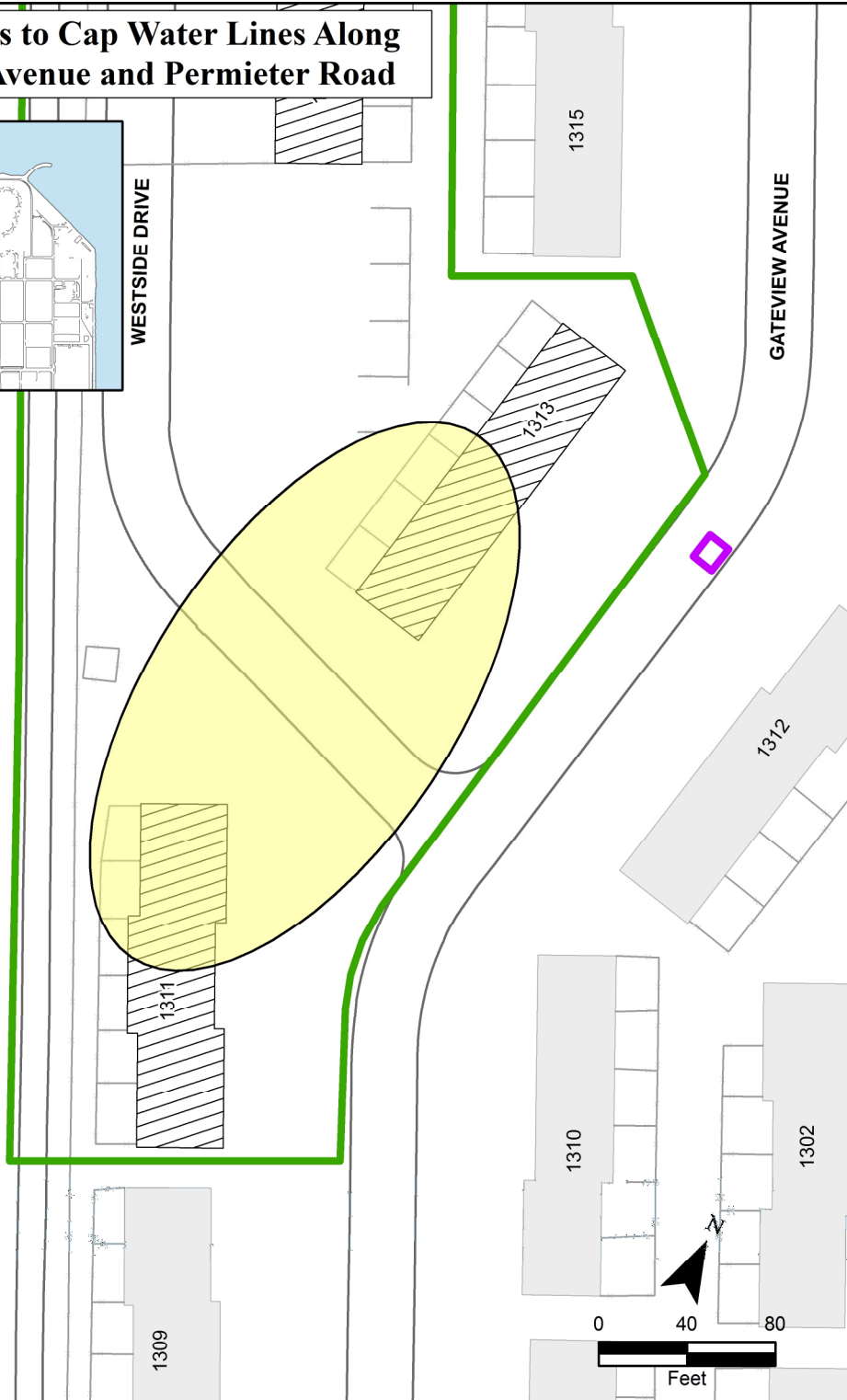

San Francisco Bay

WESTSIDE DRIVE

GATEVIEW AVENUE



LEGEND

- | | | | |
|---|--------------------------------|---|-------------------------------|
|  | EXISTING WORK AREA FENCE |  | BUILDING - EXISTING |
|  | PETROLEUM EXCAVATION AREA |  | BUILDING - ALREADY DEMOLISHED |
|  | PLANNED LOCATION OF EXCAVATION |  | ROAD |
| | |  | FENCE |