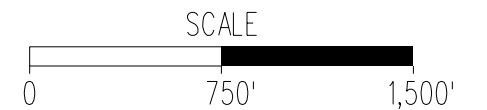


**NOTES:**

1. EXISTING TOPOGRAPHIC AND PLANIMETRIC INFORMATION PROVIDED BY DEWBERRY.
2. THE WATERS OF THE U.S.(WOUS),INCLUDING WETLANDS,BOUNDARIES WERE DELINEATED BY DEWBERRY IN DECEMBER 2016 BASED ON THE REQUIREMENTS OF THE U.S.ARMY CORPS OF ENGINEERS (USACE) WETLANDS DELINEATION MANUAL (Y-87-1) AND THE REGIONAL SUPPLEMENT TO THE CORPS OF ENGINEERS WETLANDS DELINEATION MANUAL: ATLANTIC AND GULF COASTAL PLAIN REGION (VERSION 2.0). THESE BOUNDARIES WERE CONFIRMED TO BE JURISDICTIONAL BY THE USACE ON 10 FEBRUARY 2017 DURING A JURISDICTIONAL DETERMINATION FIELD REVIEW AND JD NAO 2017-0237 ISSUED FEBRUARY 14,2017.
3. THE PROPOSED PLANS SHOWN ON THESE IMPACT SHEETS ARE FOR PERMITTING PURPOSES ONLY.

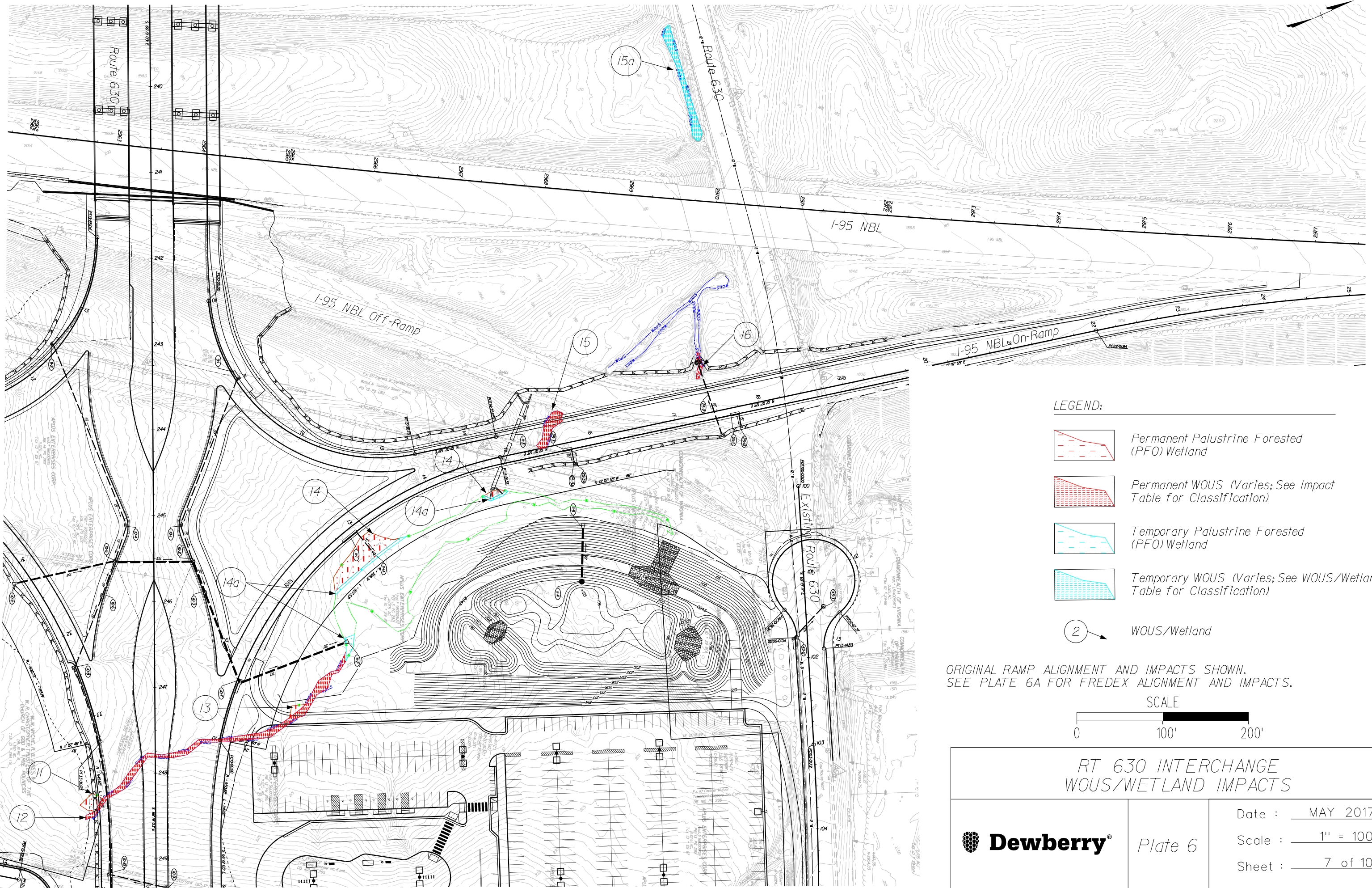


ROUTE 630 INTERCHANGE  
WETLAND DELINEATION MAP  
STAFFORD COUNTY,VIRGINIA

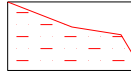
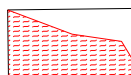
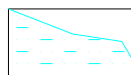
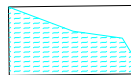



Date : MAY 2017  
Scale : 1"=750'  
Sheet : 1 OF 10

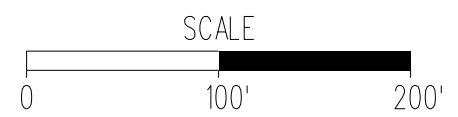




**LEGEND:**

-  Permanent Palustrine Forested (PFO) Wetland
-  Permanent WOUS (Varies; See Impact Table for Classification)
-  Temporary Palustrine Forested (PFO) Wetland
-  Temporary WOUS (Varies; See WOUS/Wetland Table for Classification)
-  WOUS/Wetland

ORIGINAL RAMP ALIGNMENT AND IMPACTS SHOWN.  
SEE PLATE 6A FOR FREDEX ALIGNMENT AND IMPACTS.



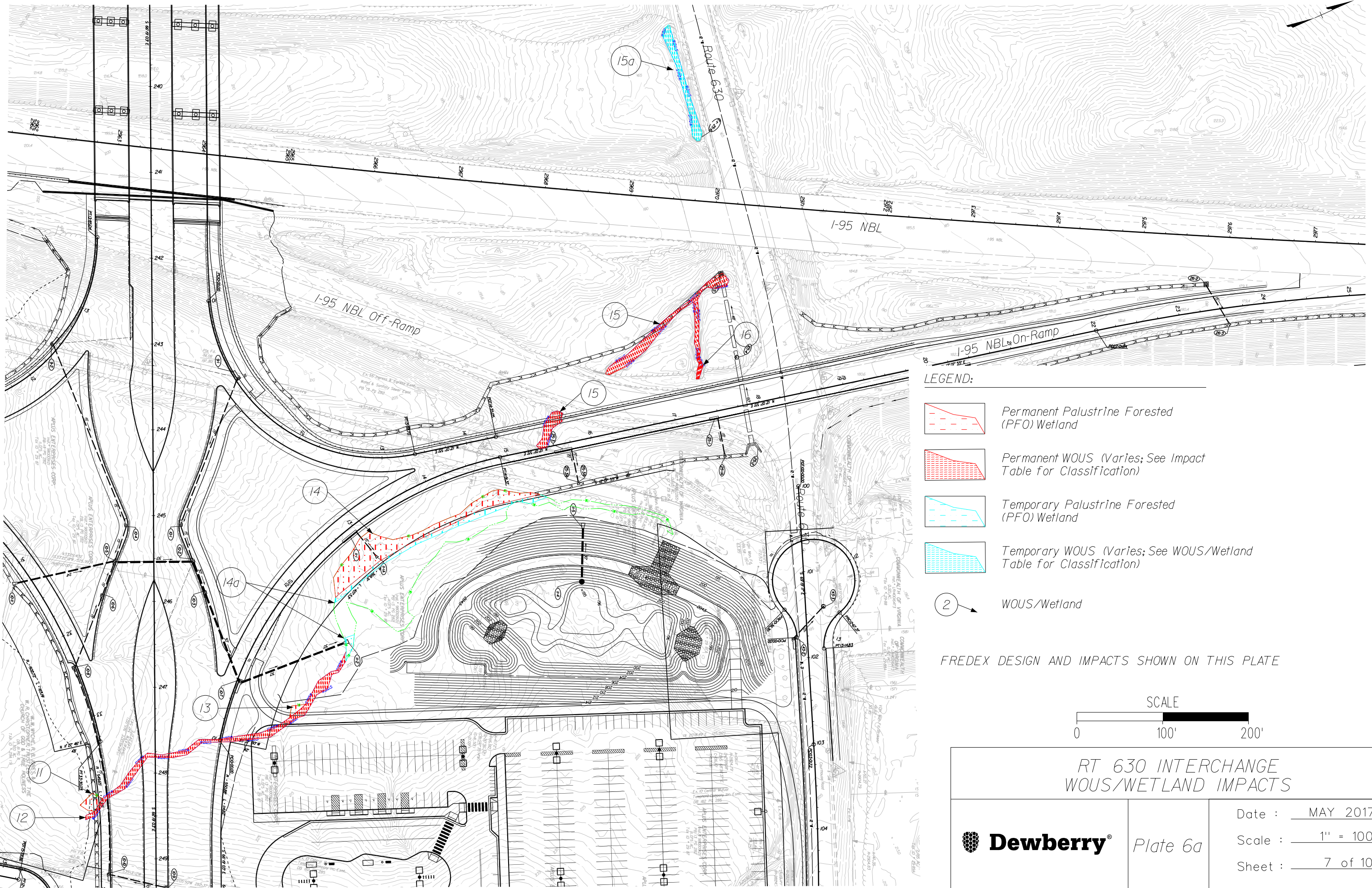
**RT 630 INTERCHANGE  
WOUS/WETLAND IMPACTS**



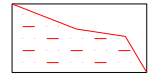
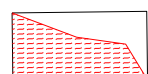
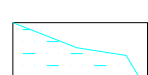
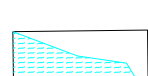

Plate 6

Date : MAY 2017  
Scale : 1" = 100'  
Sheet : 7 of 10

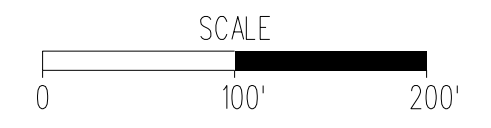





LEGEND:

-  Permanent Palustrine Forested (PFO) Wetland
-  Permanent WOUS (Varies; See Impact Table for Classification)
-  Temporary Palustrine Forested (PFO) Wetland
-  Temporary WOUS (Varies; See WOUS/Wetland Table for Classification)
-  WOUS/Wetland

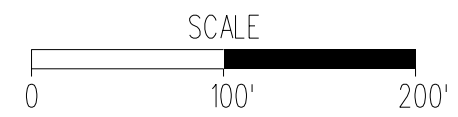
FREDEX DESIGN AND IMPACTS SHOWN ON THIS PLATE



RT 630 INTERCHANGE  
WOUS/WETLAND IMPACTS

	Plate 6a	Date : MAY 2017
		Scale : 1" = 100'
		Sheet : 7 of 10





# RT 630 INTERCHANGE WOUS/WETLAND IMPACTS

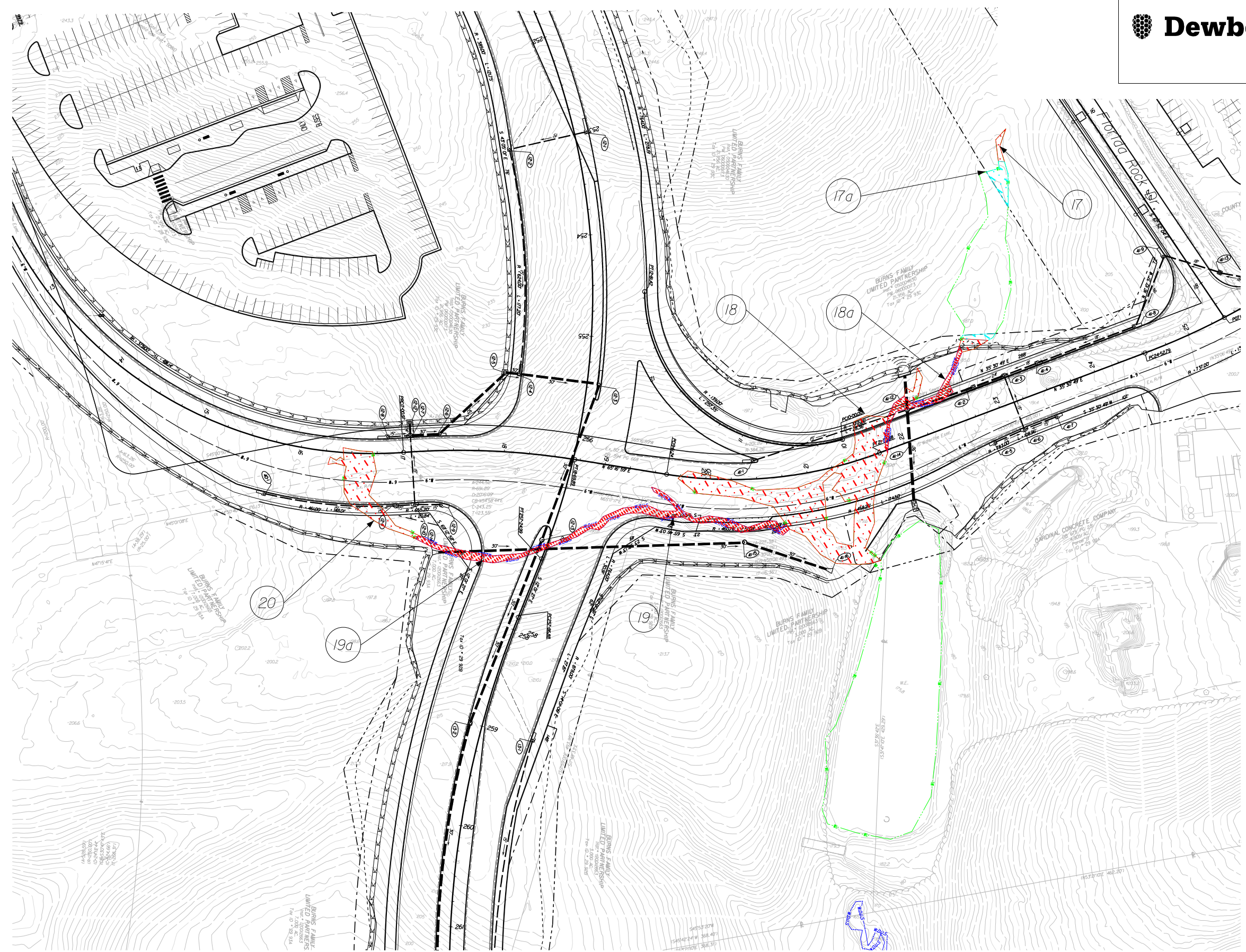


Plate 7

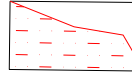
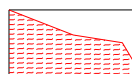
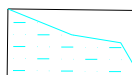

Date : MAY 2017

Scale : 1" = 100'

Sheet : 8 of 10



### LEGEND:

-  Permanent Palustrine Forested (PFO) Wetland
-  Permanent WOUS (Varies; See Impact Table for Classification)
-  Temporary Palustrine Forested (PFO) Wetland
-  Impact Number

MATCHLINE PLATE 8

Continues (Plate 8)



# RT 630 INTERCHANGE WOUS/WETLAND IMPACTS



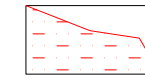
Plate 8

Date : MAY 2017

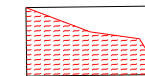
Scale : 1" = 100'

Sheet : 9 of 10

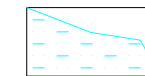
LEGEND:



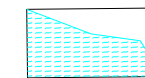
Permanent Palustrine Forested (PFO) Wetland



Permanent WOUS (Varies; See Impact Table for Classification)



Temporary Palustrine Forested (PFO) Wetland

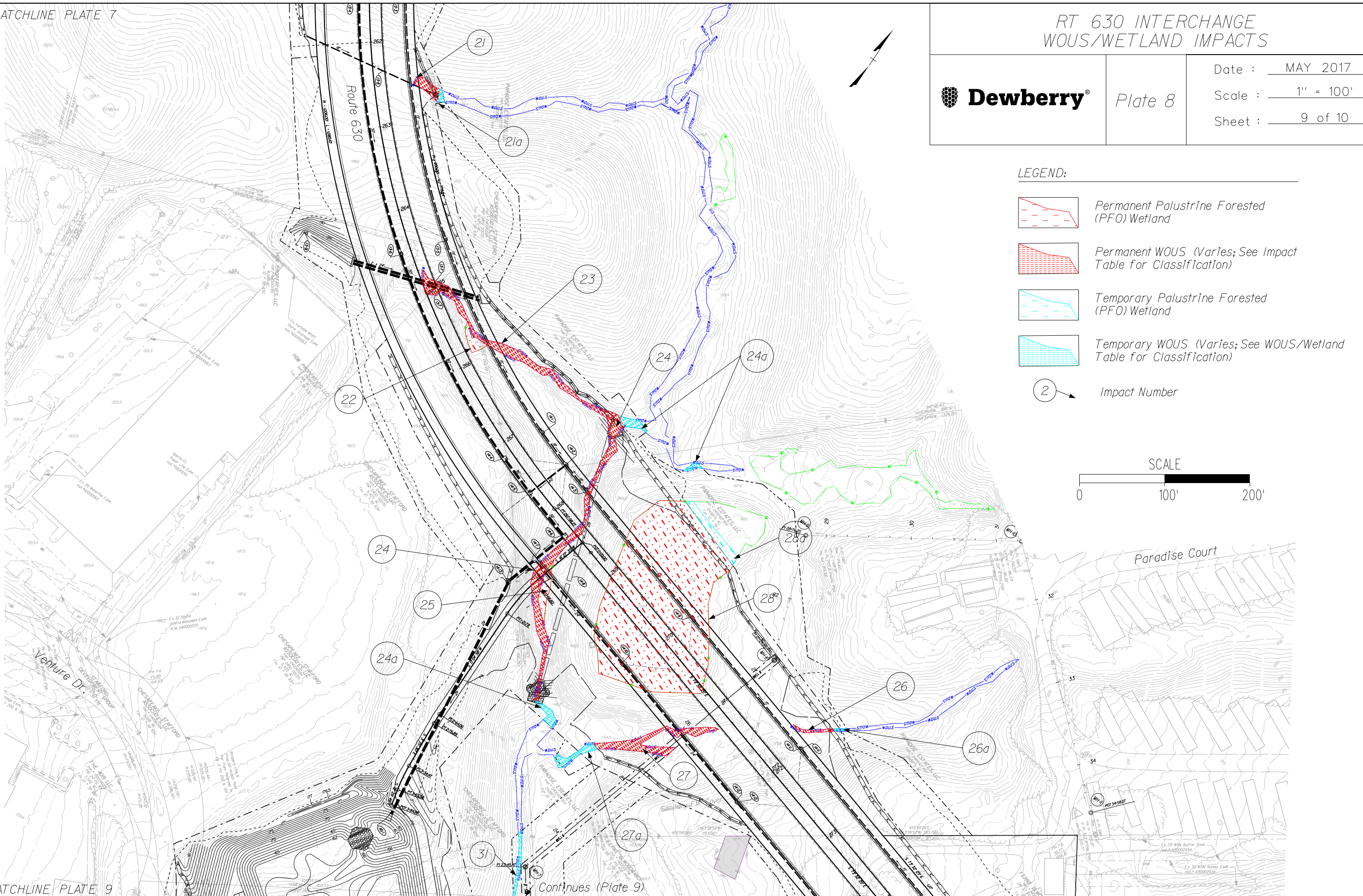
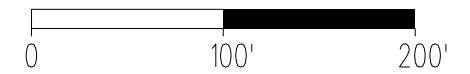


Temporary WOUS (Varies; See WOUS/Wetland Table for Classification)



Impact Number

SCALE



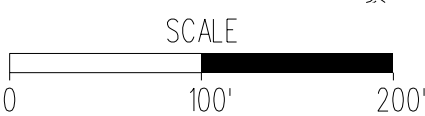


MATCHLINE PLATE 8

Venture Dr.

Route 630

Route 1



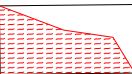
RT 630 INTERCHANGE  
WOUS/WETLAND IMPACTS

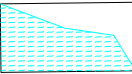
Date : MAY 2017  
 Scale : 1" = 100'  
 Sheet : 10 of 10



Plate 9

LEGEND:

 Permanent WOUS (Varies; See Impact Table for Classification)

 Temporary WOUS (Varies; See WOUS/Wetland Table for Classification)

 Impact Number

