

SITE PLAN OF PROPOSED DREDGE PROJECT

SEQUENCE & TIME LINE OF CONSTRUCTION

1. OBTAIN ALL NECESSARY PERMITS
2. HOLD PRECONSTRUCTION MEETINGS
3. DREDGE DRIVEWAYS
4. TRANSFER SPOILS TO TRUCKS FOR DISPOSAL
5. RESTORE TRANSFER SITE WITH IN KIND REPLACEMENT OF GROUND
6. COVER AND VEGETATION

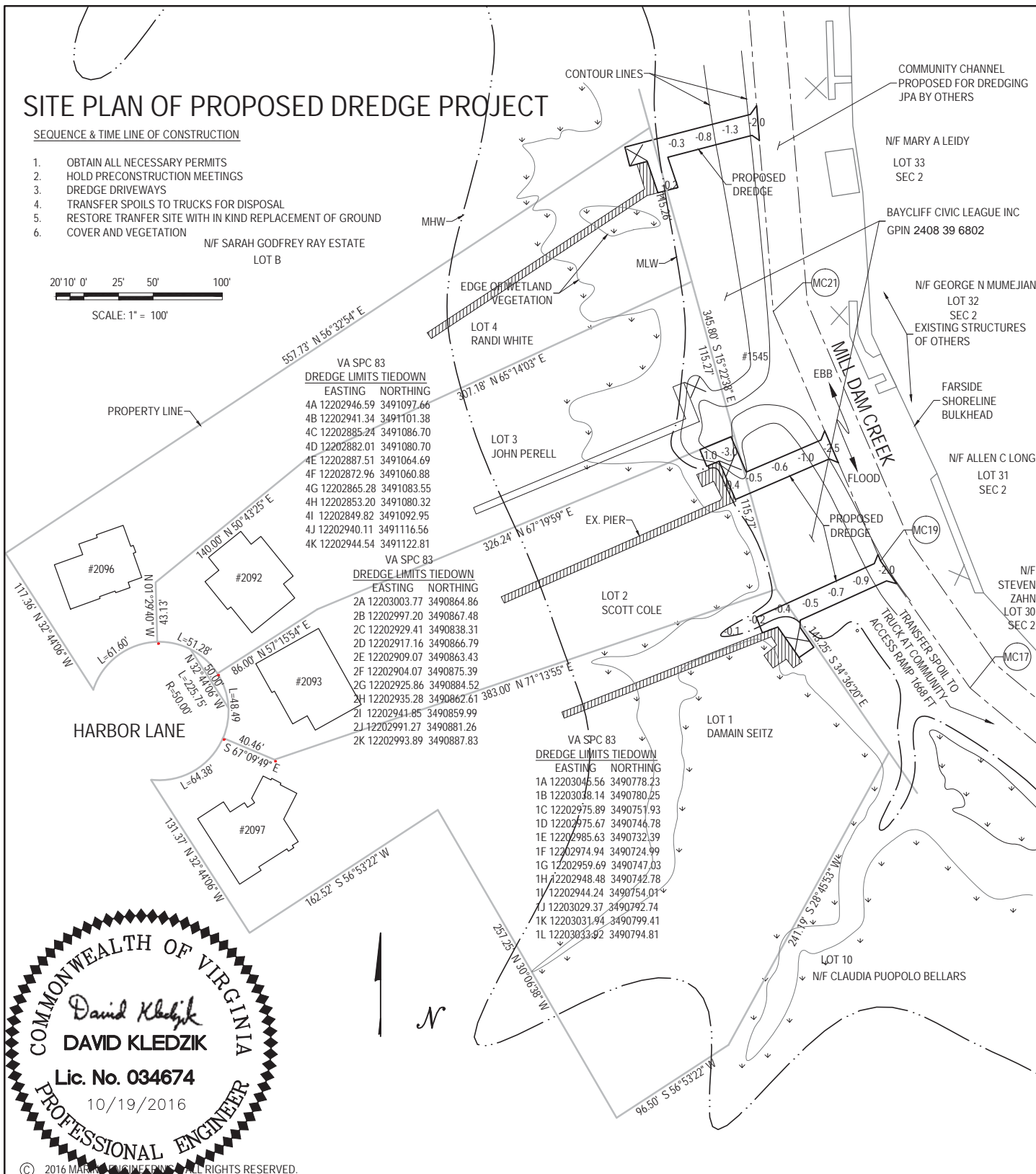
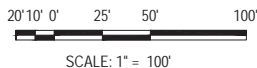

N/F SARAH GODFREY RAY ESTATE
LOT B

VA SPC 83
DREDGE LIMITS TIEDOWN

EASTING	NORTHING
4A 12202946.59	3491097.66
4B 12202941.34	3491101.38
4C 12202885.24	3491086.70
4D 12202882.01	3491080.70
4E 12202887.51	3491064.69
4F 12202872.96	3491060.88
4G 12202865.28	3491083.55
4H 12202853.20	3491080.32
4I 12202849.82	3491092.95
4J 12202940.11	3491116.56
4K 12202944.54	3491122.81

VA SPC 83
DREDGE LIMITS TIEDOWN

EASTING	NORTHING
2A 12203003.77	3490864.86
2B 12202997.20	3490867.48
2C 12202929.41	3490838.31
2D 12202917.16	3490866.79
2E 12202909.07	3490863.43
2F 12202904.07	3490875.39
2G 12202925.86	3490884.52
2H 12202935.28	3490862.61
2I 12202941.85	3490859.99
2J 12202991.27	3490881.26
2K 12202993.89	3490887.83

VA SPC 83
DREDGE LIMITS TIEDOWN

EASTING	NORTHING
1A 12203045.56	3490778.23
1B 12203038.14	3490780.25
1C 12202975.89	3490751.93
1D 12202975.67	3490746.78
1E 12202985.63	3490732.39
1F 12202974.94	3490724.99
1G 12202959.69	3490747.03
1H 12202948.48	3490742.78
1I 12202944.24	3490754.01
1J 12203029.37	3490792.74
1K 12203031.94	3490799.41
1L 12203033.92	3490794.81



APPLICANTS: SEITZ, COLE, WHITE
2097, 2093, 2096 HARBOR LANE
VIRGINIA BEACH, VA 23454

ADJACENT PROPERTY OWNERS
SEE SITE PLAN

MARINE ENGINEERING
4212 DOUGHERTY CT
VIRGINIA BEACH, VA 23455
PH: (757) 477-4787

PROPOSED PROJECT FOR IMPROVED
WATERCRAFT ACCESS

DATUM: MLW = 0.00'

SHEET 1 OF 10
DATE: MAY 17, 2016
REVISION 1: OCTOBER 19, 2016

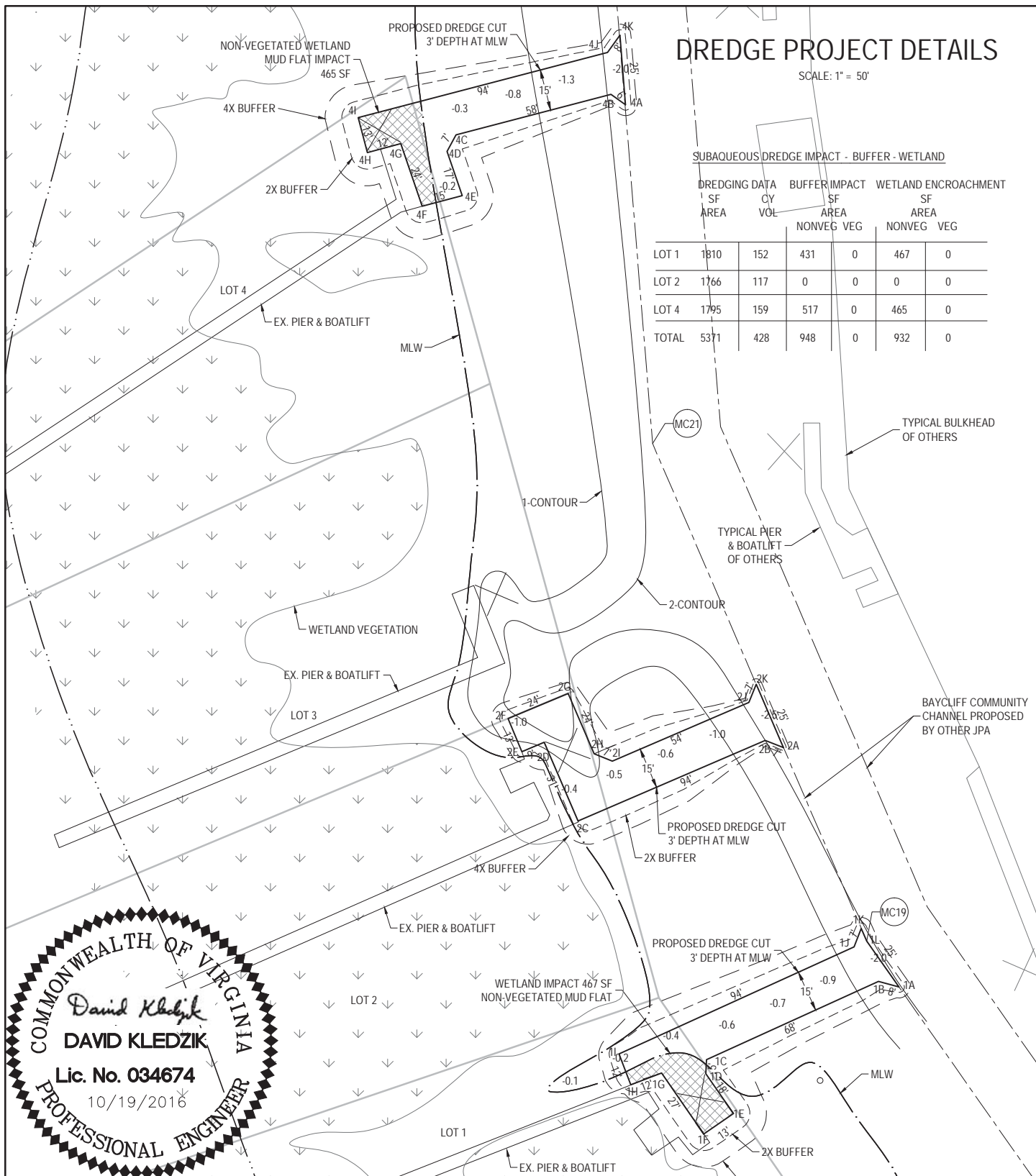

DREDGE PROJECT DETAILS

SCALE: 1" = 50'

SUBAQUEOUS DREDGE IMPACT - BUFFER - WETLAND

	DREDGING DATA SF AREA	CY VOL	BUFFER IMPACT		WETLAND ENCROACHMENT	
			SF NONVEG	SF VEG	SF NONVEG	SF VEG
LOT 1	1810	152	431	0	467	0
LOT 2	1766	117	0	0	0	0
LOT 4	1795	159	517	0	465	0
TOTAL	5371	428	948	0	932	0

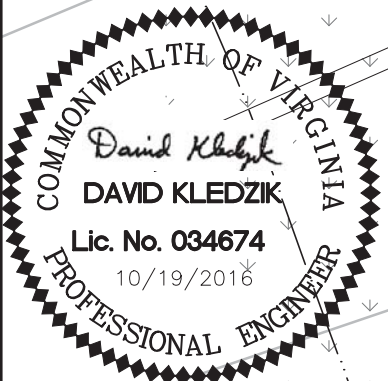

APPLICANTS:
SEITZ, COLE, WHITE
2093, 2096, 2097 HARBOR LANE
VIRGINIA BEACH, VA 23454

MARINE ENGINEERING
4212 DOUGHERTY CT
VIRGINIA BEACH, VA 23455
PH: (757) 477-4787

PROPOSED PROJECT FOR
IMPROVED WATERCRAFT ACCESS
DATUM: MLW = 0.00'
SHEET 2 OF 10
DATE: MAY 17, 2016
REVISION 1: OCTOBER 19, 2016

DREDGE PROJECT DETAILS
LOT 4

SCALE: 1" = 20'

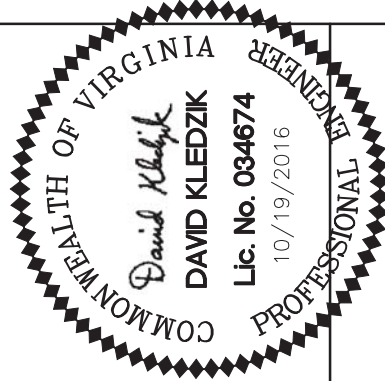
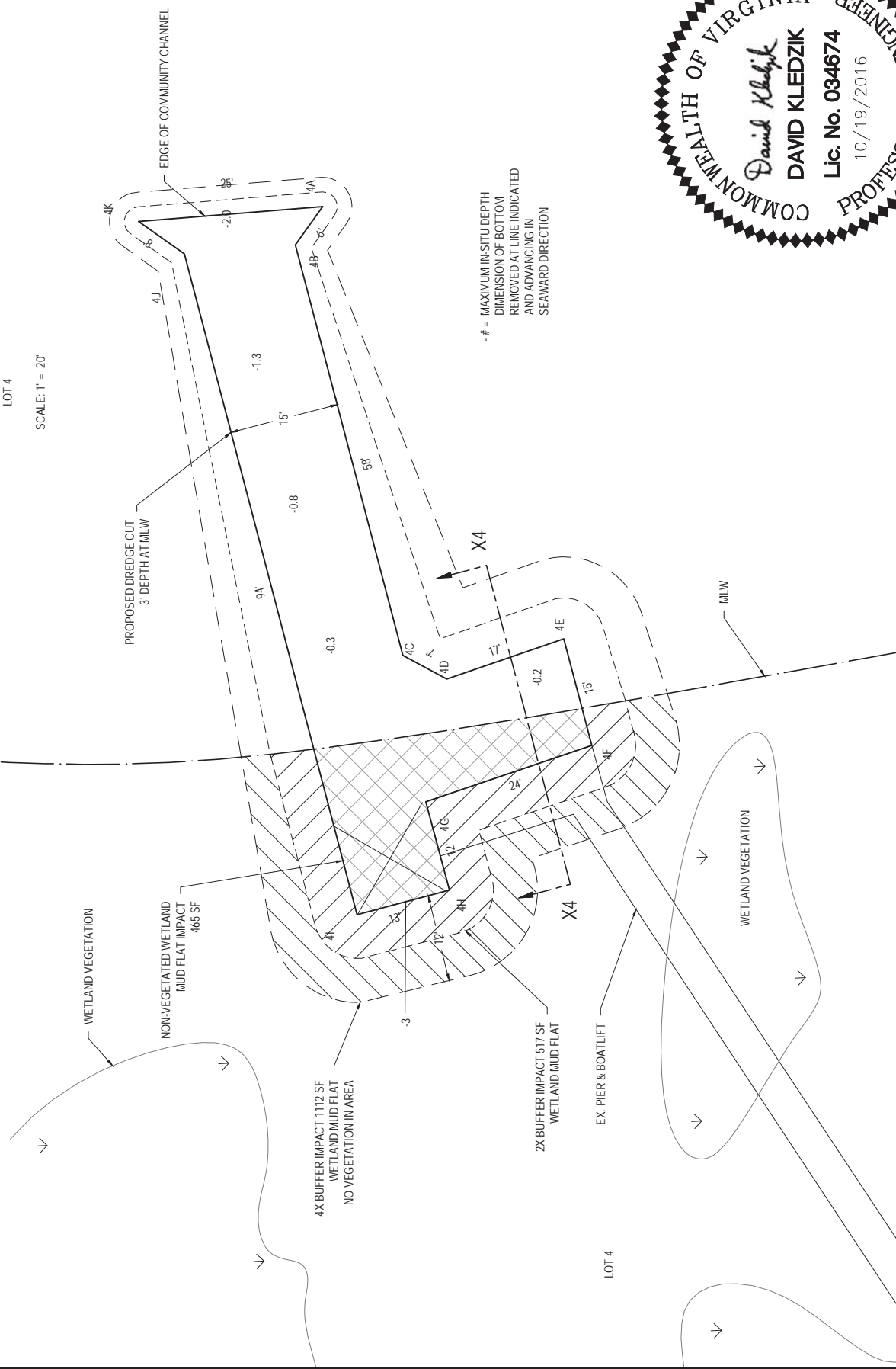

PROPOSED PROJECT FOR
IMPROVED WATERCRAFT ACCESS
DATUM: MLW = 0.00'
SHEET 3 OF 10
DATE: MAY 17, 2016
REVISION 1: OCTOBER 19, 2016

MARINE ENGINEERING
4212 DOUGHERTY CT
VIRGINIA BEACH, VA 23455
PH: (757) 477-4787

APPLICANTS:
SEITZ, COLE, WHITE
2093, 2096, 2097 HARBOR LANE
VIRGINIA BEACH, VA 23454

DREDGE PROJECT DETAILS

LOT 2

SCALE: 1" = 20'

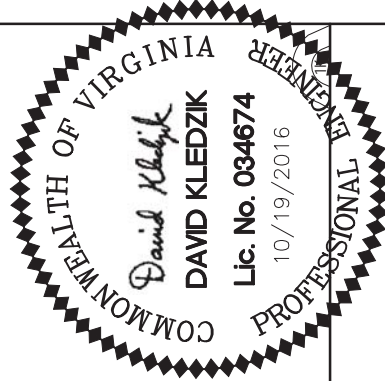
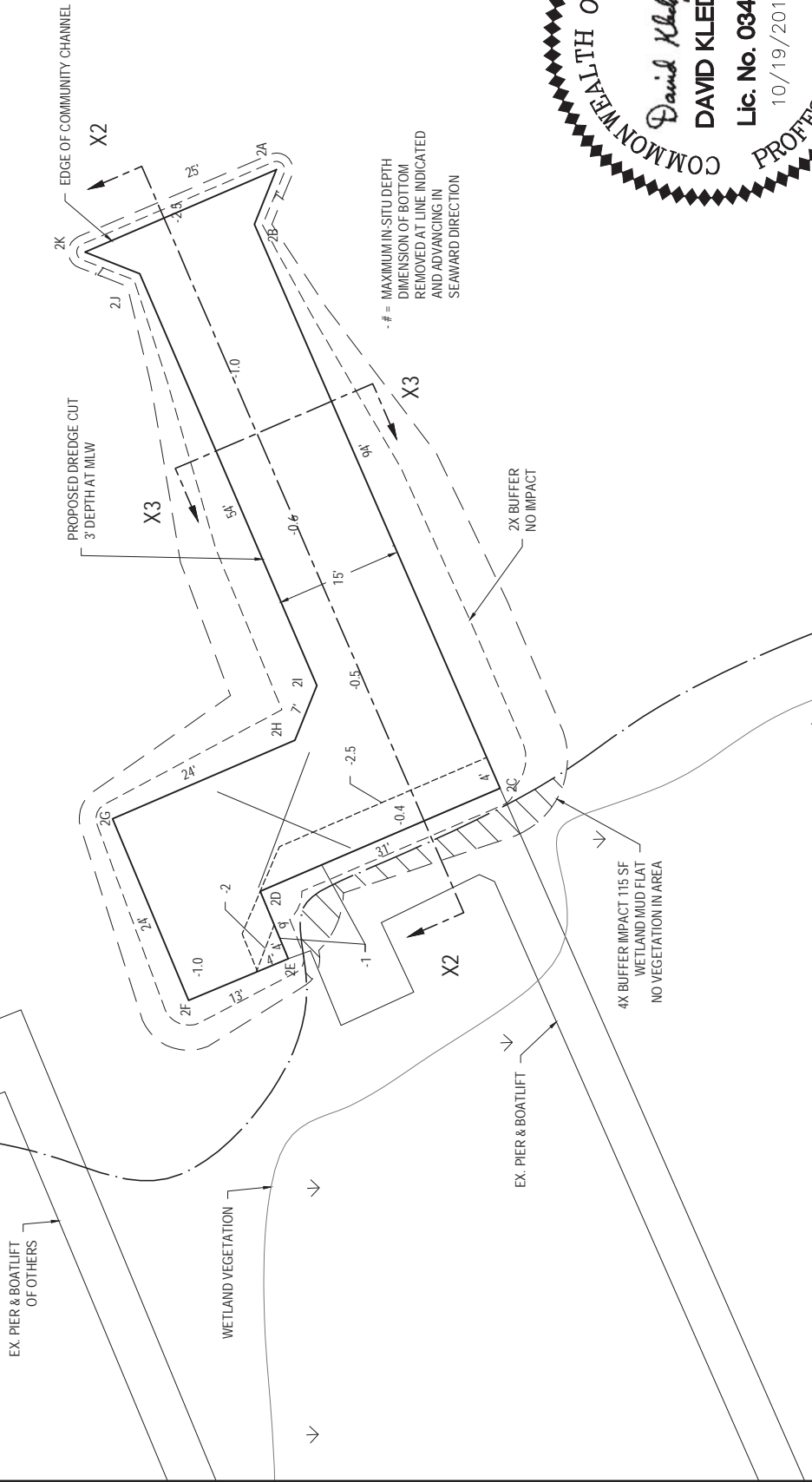

PROPOSED PROJECT FOR
IMPROVED WATERCRAFT ACCESS

DATUM: MLW = 0.00'
SHEET 4 OF 10
DATE: MAY 17, 2016
REVISION 1: OCTOBER 19, 2016

MARINE ENGINEERING
4212 DOUGHERTY CT
VIRGINIA BEACH, VA 23455
PH: (757) 477-4787

APPLICANTS:
SEITZ, COLE, WHITE
2093, 2096, 2097 HARBOR LANE
VIRGINIA BEACH, VA 23454

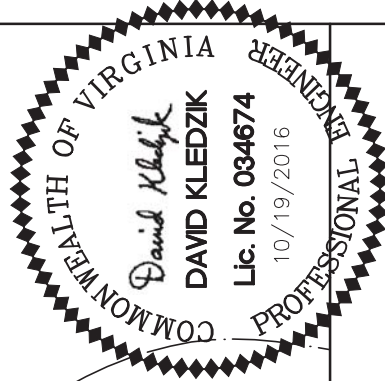
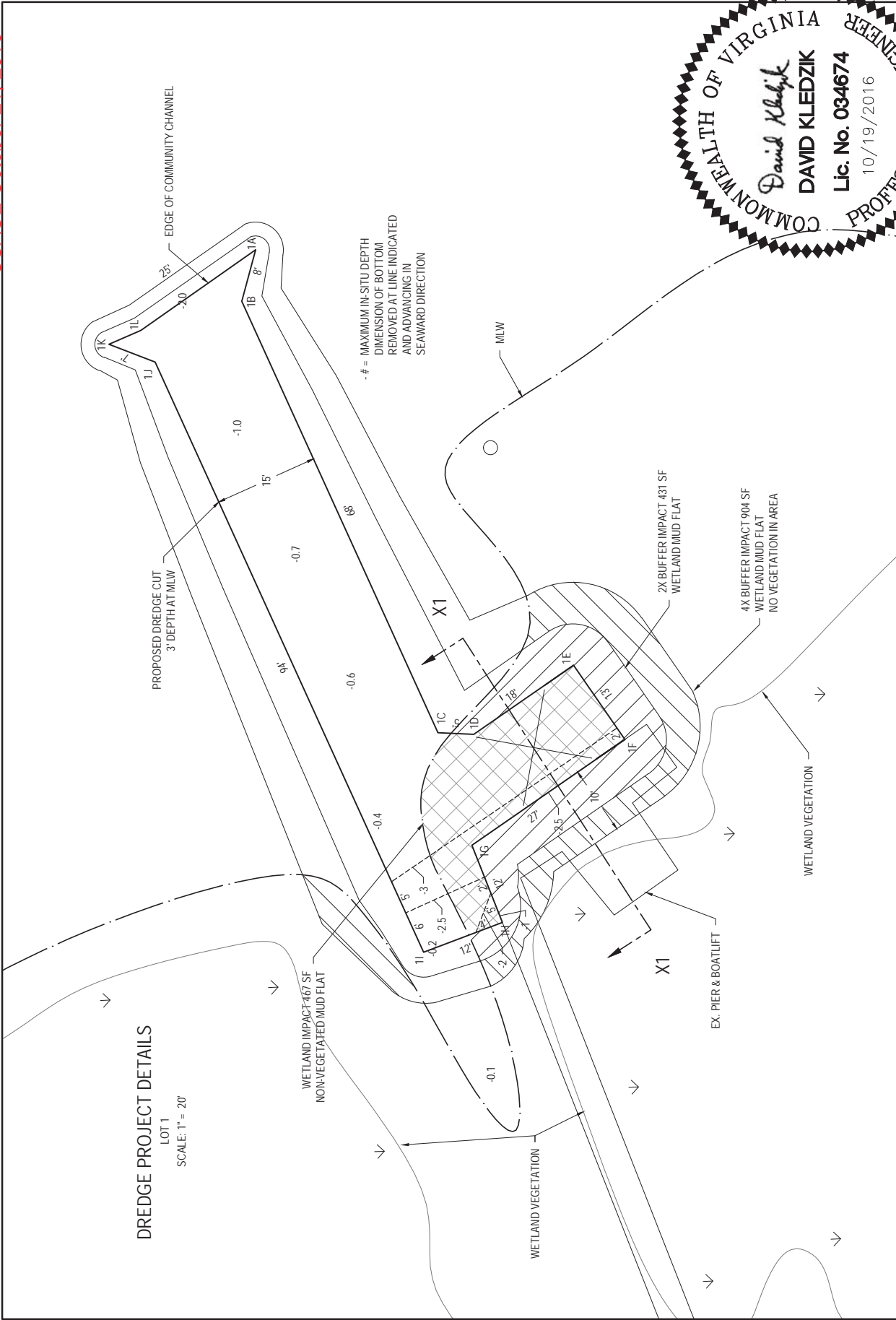

PROPOSED PROJECT FOR
 IMPROVED WATERCRAFT ACCESS
 DATUM: MLW = 0.00'
 SHEET 5 OF 10
 DATE: MAY 17, 2016
 REVISION 1: OCTOBER 19, 2016

MARINE ENGINEERING
 4212 DOUGHERTY CT
 VIRGINIA BEACH, VA 23455
 PH: (757) 477-4787

APPLICANTS:
 SEITZ, COLE, WHITE
 2093, 2096, 2097 HARBOR LANE
 VIRGINIA BEACH, VA 23454

SECTION X1-X1 PROPOSED CANAL DREDGING DETAILS

SCALE: 1" = 5'

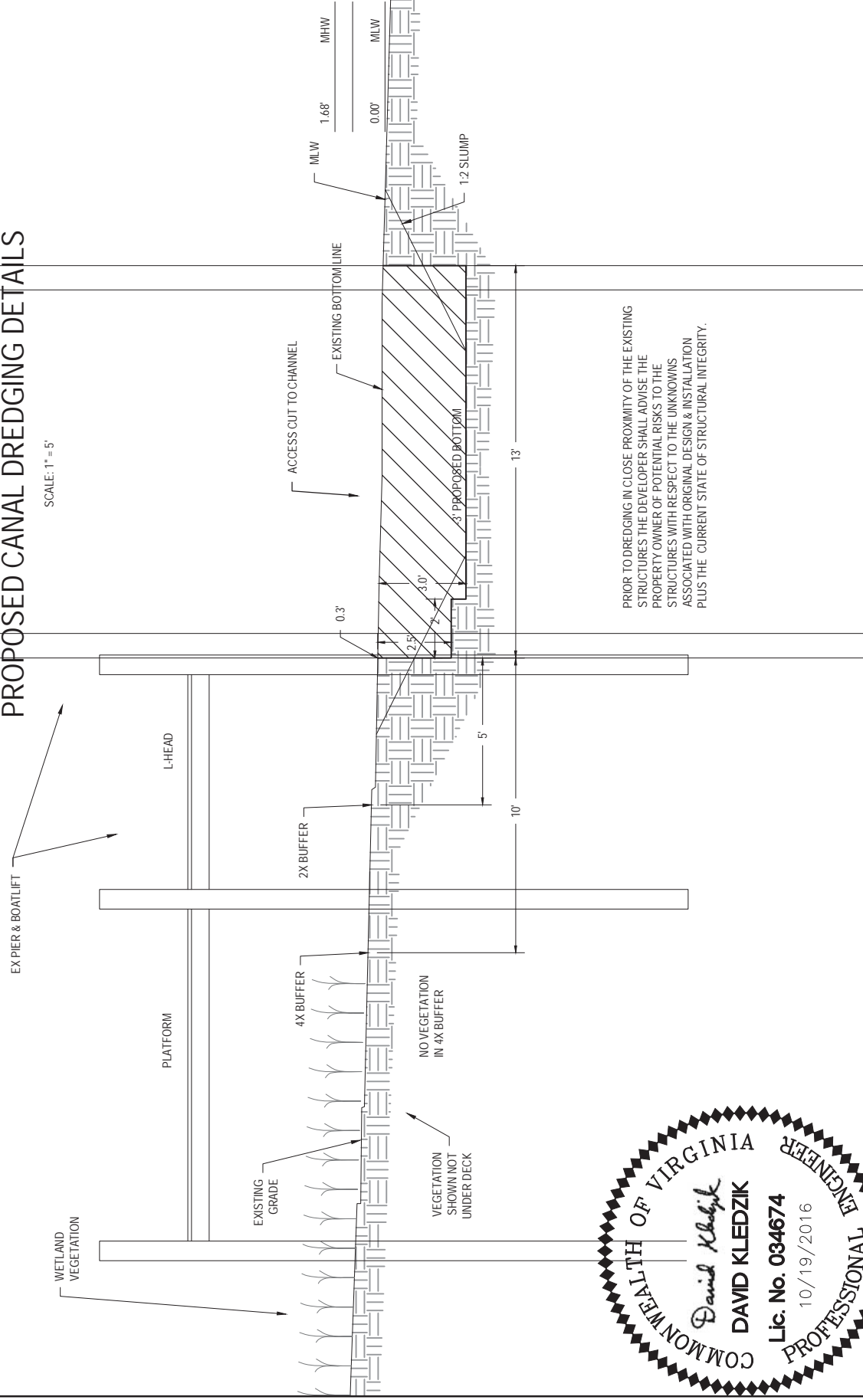

PRIOR TO DREDGING IN CLOSE PROXIMITY OF THE EXISTING STRUCTURES THE DEVELOPER SHALL ADVISE THE PROPERTY OWNER OF POTENTIAL RISKS TO THE STRUCTURES WITH RESPECT TO THE UNKNOWN ASSOCIATED WITH ORIGINAL DESIGN & INSTALLATION PLUS THE CURRENT STATE OF STRUCTURAL INTEGRITY.



PROPOSED PROJECT FOR
 IMPROVED WATERCRAFT ACCESS
 DATUM: MLW = 0.00'
 SHEET 6 OF 10
 DATE: MAY 17, 2016
 REVISION 1: OCTOBER 19, 2016

MARINE ENGINEERING
 4212 DOUGHERTY CT
 VIRGINIA BEACH, VA 23455
 PH: (757) 477-4787

APPLICANTS:
 SEITZ, COLE, WHITE
 2093, 2096, 2097 HARBOR LANE
 VIRGINIA BEACH, VA 23454

SECTION X2-X2 PROPOSED CANAL DREDGING DETAILS

SCALE: 1" = 12'

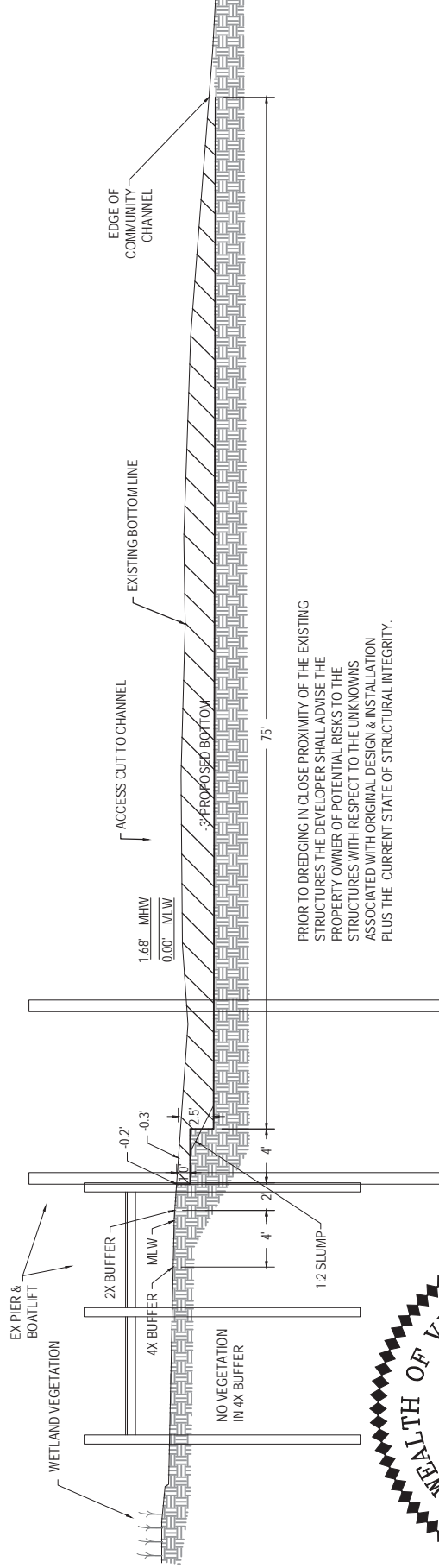

PRIOR TO DREDGING IN CLOSE PROXIMITY OF THE EXISTING STRUCTURES THE DEVELOPER SHALL ADVISE THE PROPERTY OWNER OF POTENTIAL RISKS TO THE STRUCTURES WITH RESPECT TO THE UNKNOWNNS ASSOCIATED WITH ORIGINAL DESIGN & INSTALLATION PLUS THE CURRENT STATE OF STRUCTURAL INTEGRITY.



<p>APPLICANTS: SEITZ, COLE, WHITE 2093, 2096, 2097 HARBOR LANE VIRGINIA BEACH, VA 23454</p>	<p>MARINE ENGINEERING 4212 DOUGHERTY CT VIRGINIA BEACH, VA 23455 PH: (757) 477-4787</p>	<p>PROPOSED PROJECT FOR IMPROVED WATERCRAFT ACCESS DATUM: MLW = 0.00' SHEET 7 OF 10 DATE: MAY 17, 2016 REVISION 1: OCTOBER 19, 2016</p>
---	---	---

SECTION X3-X3 PROPOSED CANAL DREDGING DETAILS

SCALE: 1" = 5'

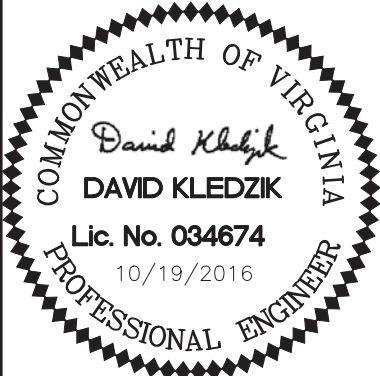
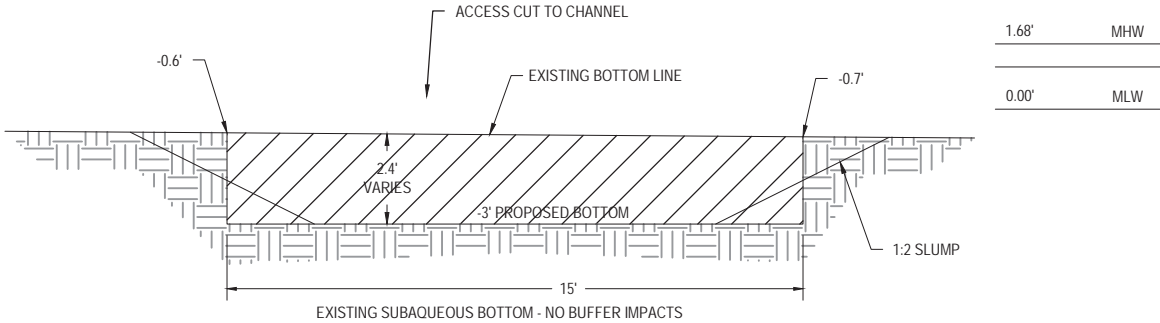

APPLICANTS:
SEITZ, COLE, WHITE
2093, 2096, 2097 HARBOR LANE
VIRGINIA BEACH, VA 23454

MARINE ENGINEERING
4212 DOUGHERTY CT
VIRGINIA BEACH, VA 23455
PH: (757) 477-4787

PROPOSED PROJECT FOR
IMPROVED WATERCRAFT ACCESS
DATUM: MLW = 0.00'
SHEET 8 OF 10
DATE: MAY 17, 2016
REVISION 1: OCTOBER 19, 2016

SECTION X4-X4 PROPOSED CANAL DREDGING DETAILS

SCALE: 1" = 5'

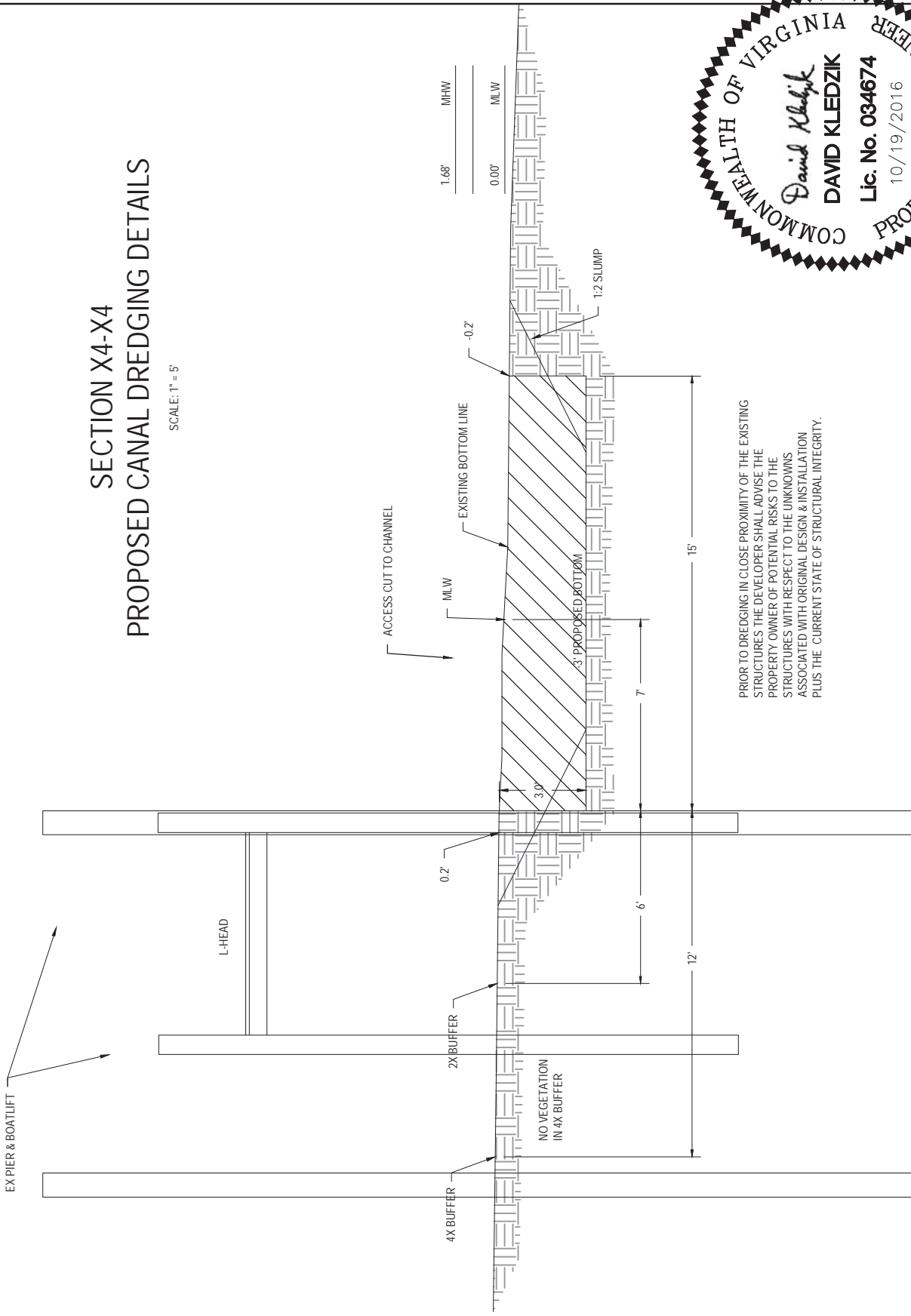

PRIOR TO DREDGING IN CLOSE PROXIMITY OF THE EXISTING STRUCTURES THE DEVELOPER SHALL ADVISE THE PROPERTY OWNER OF POTENTIAL RISKS TO THE STRUCTURES WITH RESPECT TO THE UNKNOWN ASSOCIATED WITH ORIGINAL DESIGN & INSTALLATION PLUS THE CURRENT STATE OF STRUCTURAL INTEGRITY.



PROPOSED PROJECT FOR
IMPROVED WATERCRAFT ACCESS

DATUM: MLW = 0.00'

SHEET 9 OF 10

DATE: MAY 17, 2016

REVISION 1: OCTOBER 19, 2016

MARINE ENGINEERING

4212 DOUGHERTY CT
VIRGINIA BEACH, VA 23455
PH: (757) 477-4787

APPLICANTS: WHITE
SEITZ, COLE, 2097 HARBOR LANE
VIRGINIA BEACH, VA 23454

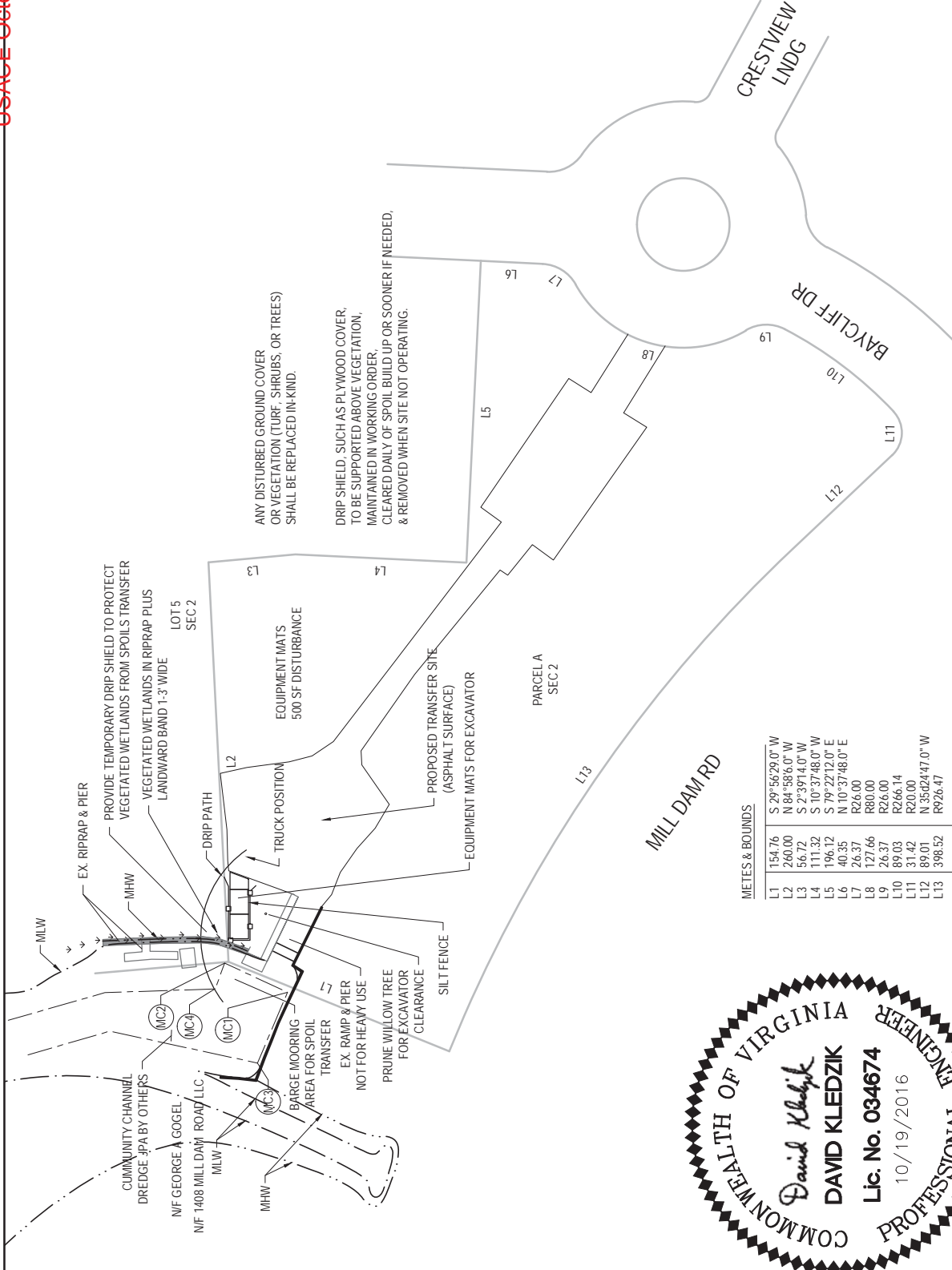

METES & BOUNDS

L1	154.76	S 29°56'29.0" W
L2	260.00	N 84°58'6.0" W
L3	56.72	S 2°39'14.0" W
L4	111.32	S 10°37'48.0" W
L5	196.12	S 79°22'12.0" E
L6	40.35	N 10°37'48.0" E
L7	26.37	R26.00
L8	127.66	R80.00
L9	26.37	R26.00
L10	89.03	R266.14
L11	31.42	R20.00
L12	89.01	N 35°02'47.0" W
L13	398.52	R926.47



APPLICANTS:
 SEITZ, COLE, WHITE
 2093, 2096, 2097 HARBOR LANE
 VIRGINIA BEACH, VA 23454

MARINE ENGINEERING
 4212 DOUGHERTY CT
 VIRGINIA BEACH, VA 23455
 PH: (757) 477-4787

**PROPOSED PROJECT FOR
 IMPROVED WATERCRAFT ACCESS**
 DATUM: MLW = 0.00'
 SHEET 10 OF 10
 DATE: MAY 17, 2016
 REVISION 1: OCTOBER 19, 2016

AREA MAP OF 2097/2093/2096 HARBOR LANE VIRGINIA BEACH, VA 23451



SCALE 1" : 1200'

